

About “Research Resource Archive, Kyoto University” (KURRA)

KURRA systematically collects and preserves archival material produced in the course of the University’s educational and research activities, making them available for further use. KURRA’s efforts focus on primary source materials: photographs, films, recordings, field books, research meeting records, lecture notes, and manuscripts.

Educational and research activities of all departments of Kyoto University are included. Consequently, KURRA is overseen by a steering committee consisting of representatives from all departments, led by an executive director of the University. Based on its action program, the Kyoto University Museum (a governing entity) and Academic Center for Computing and Media Studies plan the activities of KURRA, supported by Institute for Information Management and Communication.

Resources available in the archive

KURRA resources available to the public **over the internet** or **at the Audio-Visual Station** can be classified as follows: (1) information about the archival materials, (2) digital exhibitions, and (3) video contents.

Resource types

(1) Archival materials

You can search information about the archival materials in KURRA online using KURRA’s digital archive system, called “Peek.” There are public and researcher modes*, the latter including additional restricted data.

* To use researcher mode, one of the following IDs is required:

- ECS-ID (accounts for Kyoto University students)
- SPS-ID (accounts for Kyoto University faculty and staff)
- ID of an organization party to the Academic Access Management Federation in Japan (GakuNin)

(If you have trouble logging in with these IDs, please consult the relevant department in your own organization.)

Kyoto University Digital Archive System “Peek”:

<https://peek.rra.museum.kyoto-u.ac.jp/>

(2) Digital exhibitions

Digital exhibitions are created based on the archival materials, as an application of research resources. These are available for internet viewing.

(3) Video contents

KURRA includes video contents related to the archival materials, such as historical footage collected from primary sources, videos based on the archival materials, and promotion movies of research resources. These can be viewed at the Audio-Visual Station.

(Some videos are part of a digital exhibition, and hence not in the list.)

Using research resources

References

For digital exhibitions

Follow reference examples in: “5.10 Web sites, Web pages, Blogs” of “Standards for Information of Science and Technology: How to write references”. (SIST 02-2007, <http://jipsti.jst.go.jp/sist/pdf/SIST02-2007.pdf>: in Japanese)

eg Research Resource Archive, Kyoto University. “1956–1976 Drawings of Mars by Shotaro Miyamoto”. 1956–1976 Drawings of Mars by Shotaro Miyamoto. 2012. <https://exhibit.rra.museum.kyoto-u.ac.jp/mars/>, (accessed 2016-09-08).

For archival materials

Also follow examples in 5.10, SIST 02-2007.

eg “Miyamoto (Shotaro) Papers: Drawings of Mars, 1955–1976”. Kyoto University Digital Archive System (Research Resource Archive, Kyoto University). 2011. <https://peek.rra.museum.kyoto-u.ac.jp/ark:/62587/ar20931.20931>, (accessed 2019-01-07).

For a archival material piece

Reference example: where “[Unnumbered Drawing](“1956 VII 22”)’ is the title of the material, “01–02” is the material reference number, and “RRA MSS 2008/1” is the archival material(s) reference number containing the material.

eg [Unnumbered Drawing](“1956 VII 22”). 01–02, Miyamoto (Shotaro) Papers: Drawings of Mars, 1955–1976. RRA MSS 2008/1, Kyoto University (Research Resource Archive, Kyoto University). <https://peek.rra.museum.kyoto-u.ac.jp/ark:/62587/ar20931.53572>, (accessed 2019-01-07).

Please contact us for additional questions about writing references.

Secondary use of digital data

Secondary use means the showing, publishing, broadcasting, etc of data from Peek.

Please make an inquiry prior to considering any secondary use. After a consultation, please submit a “Request for secondary use” form, clearly stating that the data is provided by the “Research Resource Archive, Kyoto University”. No alteration of the data will be permitted. Usage fees may be charged. **Note that KURRA’s research resources can only be used for research and educational purposes.**



Research Resource Archive,
Kyoto University

User's Guide

Issued on October 1, 2022

Contact **Research Resource Archive, Kyoto University**
The Kyoto University Museum, Yoshida-Honmachi
Sakyo-ku, Kyoto 606-8501 Japan
kurra-info@inet.museum.kyoto-u.ac.jp
<https://www.rra.museum.kyoto-u.ac.jp/en/>

Audio-Visual Station

Electronic access to KURRA's research resources are available via the *Peek* terminals here. Digital exhibitions based on these resources — along with related video contents — can be viewed, and the station also has sufficient space, chairs, and tables for discussions or meetings related to the archive.

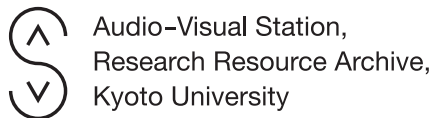

Location: Yoshida-Honmachi, Sakyo-ku, Kyoto
The Kyoto University Museum lobby

It can be used when the Kyoto University Museum is open.
Please see the museum's website for information on working days and hours.

<https://www.museum.kyoto-u.ac.jp/en/>

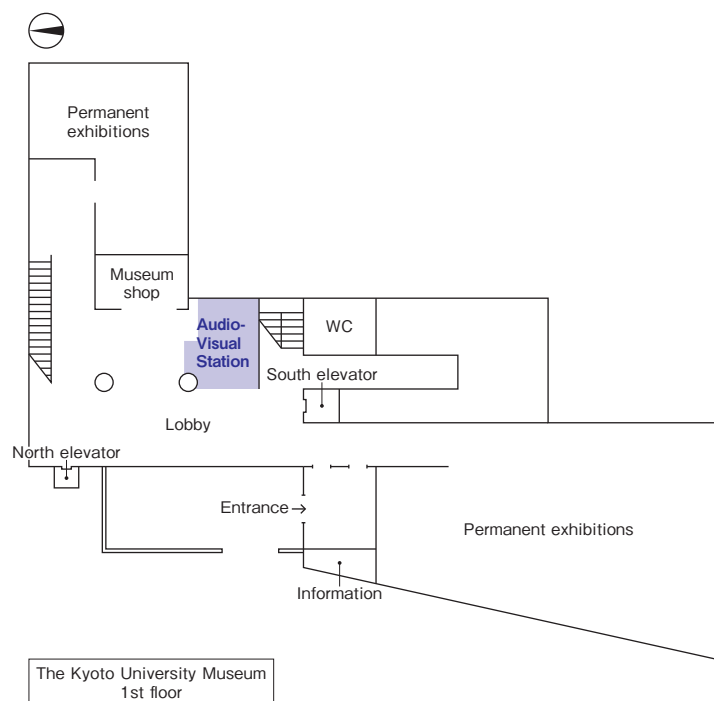

Printed resources



Flyers and leaflets related to Kyoto University and the Museum are available on the white shelf beside the gift shop. KURRA materials are also located here, and the area can be adapted for hosting a small lecture or seminar at the Audio-Visual Station.

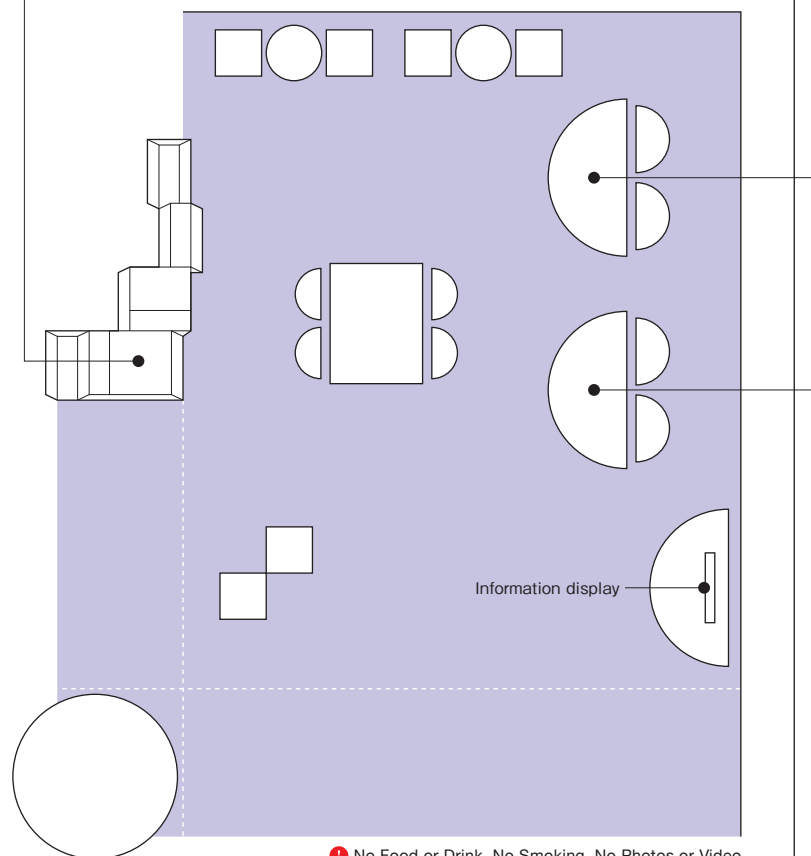

Viewing booths

Each booth is equipped with a computer terminal, keyboard, mouse, dual headphones, and a pair of speakers.
Please handle these with care.



Dual viewing booths at the Audio-Visual Station give visitors access to video contents, and also to the *Peek* system for browsing archival materials. Some materials can only be viewed inside the Audio-Visual Station, but much of the digital exhibitions are also available on the KURRA website.

Video contents on view

indicates Japanese-language footage

Road to Africa	9'31"
History of Primatology in Africa	9'50"
The Forest People of Central Africa	9'38"
Paleoanthropology in Africa	7'15"
Pastoral Societies in the Drylands of East Africa	7'54"
African Farming Societies: Agriculture in Miombos	13'44"
Evolving Study of African Cities	7'34"
Moving Continent	13'9"
Breakthrough: Yoneo Ishii and the Study of Southeast Asia	13'16"
Triangular-Rimmed Deity and Beast Mirror	11'6"
The Tomb of Sei'i Tai'shogun, SAKANOUENO TAMURAMARO	9'5"
Philosopher of Nothingness, a founder of a Japanese philosophy from ZEN Buddhism: NISHIDA KITARO	11'13"
Creative man, From Eastern thinking to theoretical physics: YUKAWA HIDEKI	12'27"
YUKAWA HIDEKI, a Profile	9'30"
Ever-Changing Universe: The Study of Universe at Kyoto University	14'28"
The Painting of the 15 Mysteries of the Madonna	23'1"
Kyoto University	15'14"
Pluripotent Cells (digest edition)	17'5"
Save the Earth and Humanity: a Challenge of the Research Institute for Sustainable Humansphere	29'9"
The MU Radar – Exploration of Middle & Upper Atmosphere	24'39"
Video related "Kawai (Masao) Collection": Talk between Masao Kawai and Juichi Yamagiwa	108'34"
Video related "Kawai (Masao) Collection": Talk between Masao Kawai and Terufumi Ohno	93'14"

(As of February 2020)